

Part Number: P-SS-SEAT(E)
Description: Sport Bucket Seats
Fitment: 2015 Polaris Slingshot
Revision: 1

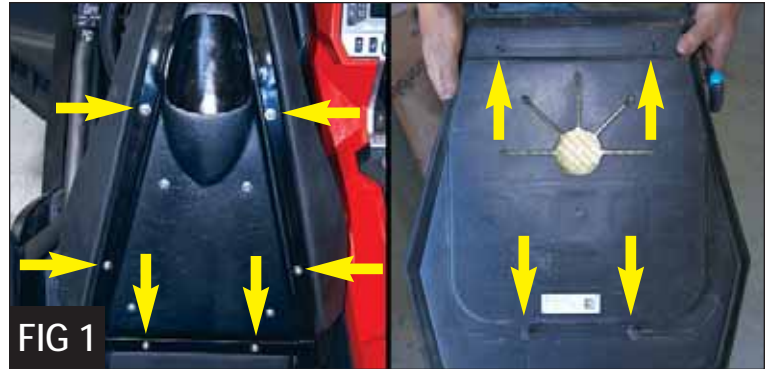

Tools Required	Parts List
Flathead screwdriver 8mm Socket wrench 4mm Allen wrench	2 #P-SS-PWR-HRN Wiring harnesses 20 6mm x 40 Button head Allen bolts 20 6mm Flat washers 6 7" Zip ties 2 Heater switches

1. Begin by removing your stock seats. Refer to your owners manual if necessary.
2. Start by removing the six 8mm bolts on the back of the stock seat and four 8mm bolts on the bottom of the stock seat, using a 8mm socket wrench (*Figure 1*).
3. Install the corbin seat, using the provided 6mm button head Allen bolts and 6mm flat washers, using a 4mm Allen wrench.



HEATER INSTALLATION:

1. First climb into the car.
2. Lift up left dashboard trim (*Figure 2*).
3. Using a flathead screwdriver, push-up the push-up pin and remove (*Figure 3*).
4. Take out the stereo by pushing down and pull back towards you (*Figure 4*).
5. Mark the plugs on the back of the stereo, so you know which position to put the plugs back in, then unplug (*Figure 5*).
6. Pull and push out the plastic piece inside the stereo cavity and pull out the side panel (*Figures 6-8*).

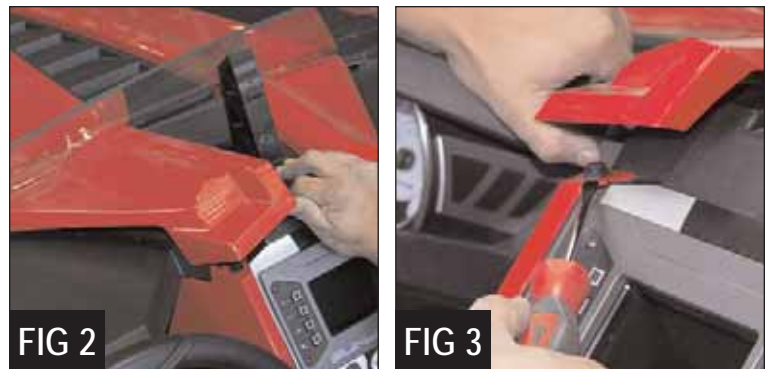

NOTE: There's double sided tape on the inside of the side panel. You may need to use a hair dryer to soften the tape to help remove the side panel (*Figure 9*). **DO NOT OVER HEAT.**

7. Using a flathead screwdriver with a piece of tape wrapped around the flathead to prevent scratching, pry up the cup holders (*Figure 10*).

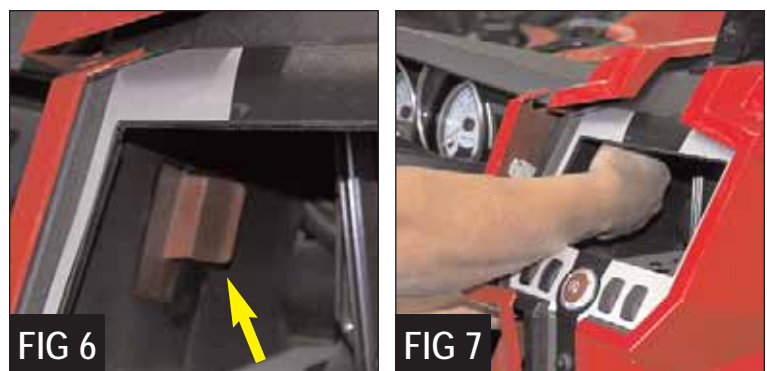

8. Squeeze the switch blanks and remove (Figures 11 & 12).

9. Push in and pull up on the shift boot (Figures 13 & 14).

10. Tilt seat forward and locate the connectors on the bottom of the Corbin seat, then connect them to the provided pigtail (Figure 15).

11. Next, connect the OEM pigtail to the Corbin pigtail (Figure 16).

12. Feed the pigtail through the seat belt hole and pull up through the cup holder (Figures 17 & 18).

NOTE: Leave enough slack to move the seat forward.

13. Repeat on the passenger side.

14. Zip tie passenger pigtails onto the frame next to the connector (Figure 19).

15. Mark the cables, so you know which one is for the driver and for the passenger.

16. Grab both pigtails and zip tie to the existing cables on the driver side (Figure 20).

17. Route the pigtails down through the cup holder and out through the center console and up to the stereo cavity (Figures 21 & 22).

18. Refer to the marks on your pigtails to determine which pigtail goes on the right and left and push them through the holes on the front switch plate panel (Figures 23 & 24).

19. Next, you are going to connect the pigtail wires onto the heater switch. The heater switch has three numbered prongs. Connect the blue wire onto prong #1. Connect the red wire onto prong #2 and connect the black wire onto prong #3 (Figures 25 & 26).

20. Put switches back into place (Figure 27).

21. Test to make sure the heater is working properly.

22. Reinstall the side panel, making sure you put the front clip in first, then push the panel into place.

23. Reinstall the push-pins and cup holders.

24. Plug in the stereo and put it back into place.

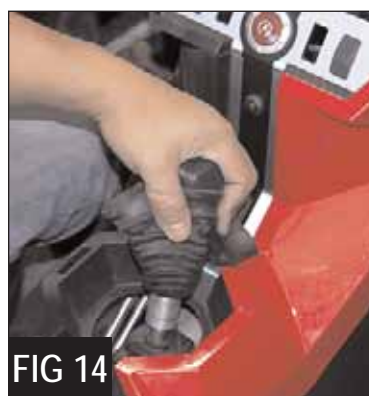

WARNING!
Heater elements should NEVER be installed in motorcycle



FIG 16



FIG 17



FIG 18



FIG 19



FIG 20



FIG 21



FIG 22



FIG 23



FIG 24



FIG 25



FIG 26



FIG 27

Questions? Give us a holler...
800-223-4332
tech@corbin.com