

**Part Number:** I-FTR-TAIL-B

**Description:** Rear Fender / Undertail kit

**Fitment:** 2019 FTR 1200 & FTR 1200 S

**Revision:** 5



Tools Required	Parts List
10mm Combination Wrench 5mm Allen Wrench 6mm Allen Wrench T-40 Torx Wrench T-30 Torx Wrench 10 mm Socket Wrench 8mm Sock Wrench Flashlight Wire cutters	4 #SP00248 8mm x 16mm Allen Bolts 4 #SP00974 6mm x 16mm Allen Bolts 4 #SP00259 6mm x 12mm Allen Bolts 12 #SP00102 1/4" Flat Washers 4 #SP00126 6mm x 1.0mm Nylock Nuts 4 #SP00285 Lock Washers 2 #P11327 Aluminum Brackets 1 #SP00460 License Plate Frame 2 6" Zip Ties

**NOTE:** We recommend the use of Blue Loctite® or similar thread lock product when assembling parts on your motorcycle.

1. Start by removing the stock seat using a T-40 torx wrench and 6mm Allen wrench.
2. Remove the bolts on the handrails to expose the seat bolts, using a T-40 torx wrench.
3. Remove the two bolts securing the seat, using a 6mm Allen wrench.
4. Remove the seat.
5. Next remove the license plate to expose these three bolts (*Figure 1*).

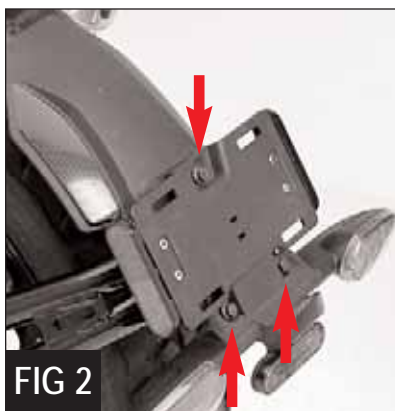

6. Remove the three bolts on the license plate bracket, using a 10mm socket wrench (*Figure 2*). Then pull out license plate bracket and unplug the three connectors (*Figure 3*).

**NOTE:** All three connectors are unique, so you don't need to mark them.

7. Remove the rubber grommet on the license plate subframe, then gently pull the wires out of the bracket (*Figure 4*).

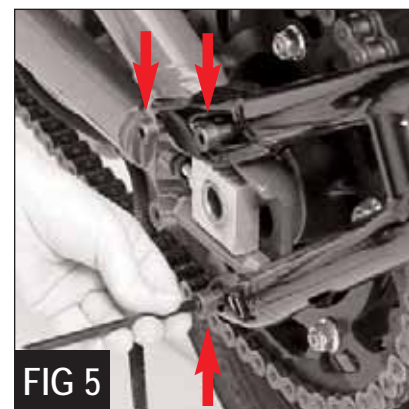

8. Disconnect the wiring pigtail and set aside.

9. Remove the three bolts holding the license plate subframe on the swingarm, using a 6mm Allen wrench (*Figure 5*).

**NOTE:** You can put the bolts back in place, discard them or replace them with some nice buttonhead Allen screws.

**NOTE:** It may be helpful to have a second pair of hands to hold the subframe while unbolting it from the swingarm.

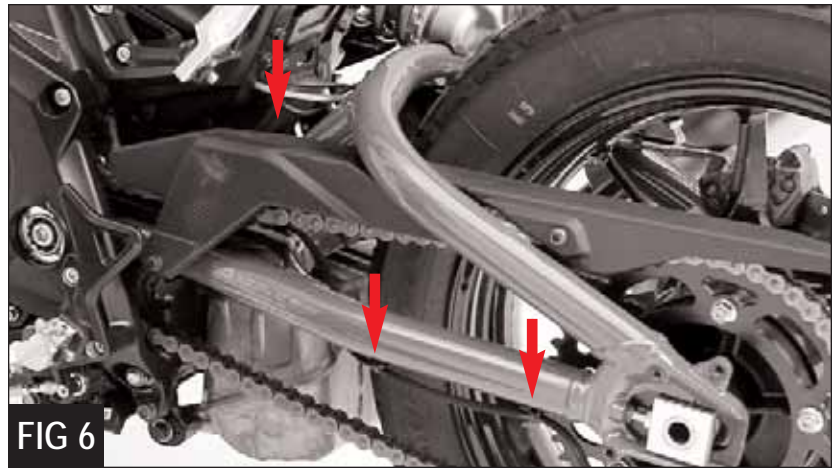

10. Next we are going to reroute the wire from the swingarm to the tail section.

11. Cut the three zip ties that secure the wires in place (*Figure 6*).

12. Push the wire towards the front of the bike, through the back of the frame, so you can grab it and gently pull it through as shown in *Figure 7*.



13. Reroute the wire under the frame and up towards the tail of the bike (*Figure 8*).



14. Remove the four 10mm bolts on the seat support bracket (*Figure 9*), then remove the two 10mm bolts from the rear of the fuel tank.

15. Get the wiring pigtail you set aside in step 8.

**NOTE:** Tape the three connector ends to make it easier to feed by spreading the connectors side by side, so they lay flat, then tape together (*Figure 10*).

16. Lift the rear of the fuel tank and feed the taped wires through the gap until you have approximately 6" on the bottom (*Figure 11*).

17. Connect the wiring pigtail to the wire you rerouted under the frame (*Figure 12*). Tuck the excess wire out of the way and under the bodywork.



18. Resecure the fuel tank with the bolts you removed earlier.



19. Reinstall the seat support bracket.

20. Remove the tape from the 3 connectors on the pigtail.

21. Pop the plastic piece off of the license plate frame (*Figures 13*).

22. Remove the turn signals on the license plate frame, using a T30 torx wrench and then transfer the turn signals onto the Corbin undertail kit (*Figure 14*). Secure with the stock bolts, but do not tighten. Use Loctite®.

**NOTE:** The turn signal with the orange wire goes on the left side of the undertail kit.

23. Using a 8mm socket wrench, transfer the license plate light on the license plate frame to the Corbin undertail kit (*Figure 15*). Secure with the stock bolts.

24. Route the turn signal wires and license plate light wire up through the center of the undertail (*Figure 16*).

25. Install the aluminum brackets onto the undertail kit, by placing the bracket on top of the undertail kit (*Figure 17*), then securing from underneath the undertail kit, using the supplied 6mm x 12mm Allen bolts, lock washers and flat washers (*Figure 18*).

**NOTE:** The brackets are universal. Just make sure when installing the brackets that they are facing out.

#### INSTALL UNDERTAIL KIT WITHOUT SADDLEBAG HARDWARE

26. Install the Corbin undertail kit, using the supplied 8mm buttonhead Allen bolts, using a 5mm allen wrench (*Figure 19*). Tighten snugly with Loctite®, but **DO NOT OVER TIGHTEN!**

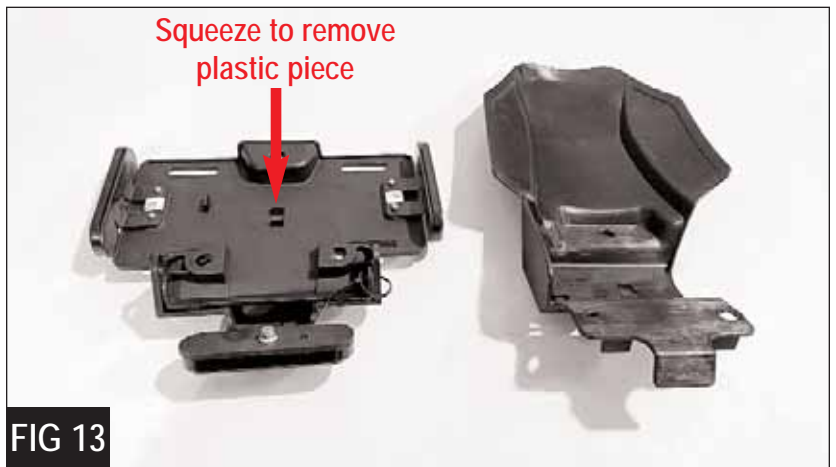

## INSTALL UNDERTAIL KIT WITH SADDLEBAG HARDWARE

27. Slide the saddlebag subframe bracket in between the channel of the Corbin undertail and align the bolt holes with the bolt locations on the motorcycle frame and secure with the supplied 8mm buttonhead Allen bolts. Repeat on the other side.

**NOTE:** Refer to #P/N 2883842 on Indian's website for your saddlebag bracket mounting instructions.

28. Reconnect the wiring to the turn signal and license plate light in the space behind the license plate. Turn the bike on and check to see if the lights are working properly.

29. Install the license plate and supplied frame if desired, on to the undertail kit, using the supplied 6mm x 16mm Allen bolt and flat washer through the top of the license plate frame and securing with a flat washer and nylock nut under the undertail kit (*Figure 20*).

30. Reinstall the seat and grab rails, using the stock bolts.



Questions? Give us a holler...  
**800-223-4332**  
tech@corbin.com